

Design R&D Euromobil and Roberto Gobbo

Project

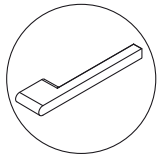

FILO'

TAG



Technical features

1. TALL UNITS

Tall and base unit Filò fronts in ossidato fusion lacquer
 Worktop in 20 mm thick Breccia Imperiale natural quartzite stone with "Sly" edging and built-in sink
 Splashback in Breccia Imperiale natural quartzite stone
 Plinth in ossidato fusion lacquer
 Nero assoluto lacquered Tag handle

2. SHELVES

60 mm thick shelves in Breccia Imperiale natural quartzite stone with integrated lighting

3. FILO' TALL UNITS

Tall unit fronts Filò in ossidato fusion lacquer and screen-printed smoked glass with a horizontally-arranged diamond pattern
 Noce TSS structure interior
 Nero assoluto lacquered Tag handle
 Frame in ossidato fusion lacquer

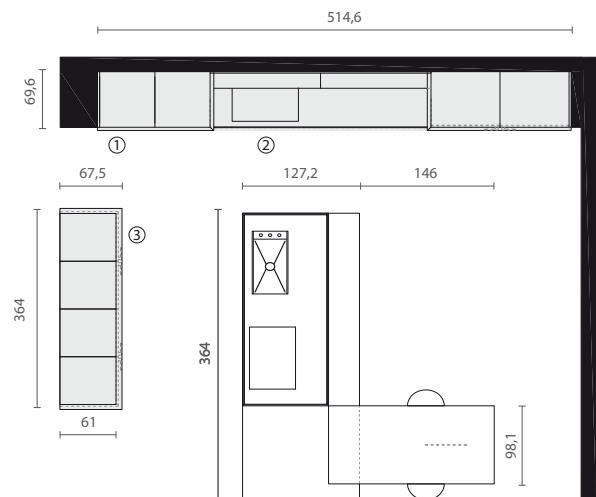

Finishes



- a. Ossidato Fusion lacquer
- b. Noce TSS
- c. Silk-printed glass
- d. Breccia Imperiale natural quartzite stone
- e. Nero assoluto lacquered aluminium

REMARKS: Elements from the FILO' project are shown in grey.

Design R&D Euromobil and Roberto Gobbo

Project

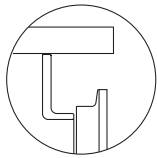

TELERO GR



Technical features

1. ISLAND

Glass Canetè nero assoluto fronts
 Worktop in 20 mm thick Breccia Imperiale natural quartzite stone with "Sly" edging and 220 mm thick "Work" block unit
 Sink made of Breccia Imperiale natural quartzite stone
 Matt nero assoluto lacquered aluminium plinth

2. BREAKFAST TABLE

40 mm thick breakfast table veneered with thermotreated Castagno Termotrattato with 45° edges
 Leggera leg in 12 mm thick extra-clear, transparent, tempered glass.

3. CHAIRS

Tè chairs from the Désirée collection designed by Setsu & Shinobu Ito featuring a Carbone stained ash frame and a seat padded with polyurethane foam and upholstered in Fashion Nera leather.

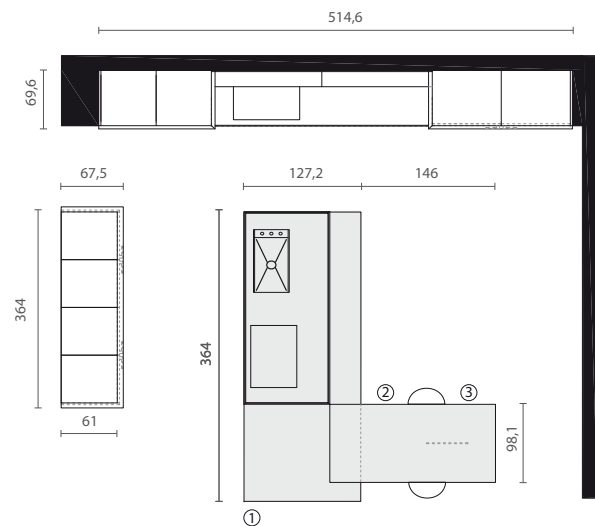

Finishes

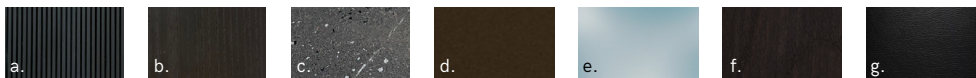

- a. Nero assoluto Canetè glass
- b. Thermotreated castagno termotrattato
- c. Breccia Imperiale natural quartzite stone
- d. Matt nero assoluto lacquered aluminium
- e. Extra-clear transparent glass
- f. Carbone stained ash frame
- g. Black Fashion leather

REMARKS: Elements from the TELERO project are shown in grey.