

Design R&D Euromobil and Roberto Gobbo

Project

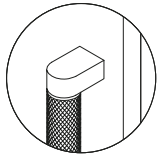

LAIN PLAN

TONDONE



Technical features

1. CABINET FOLDING

A storage system featuring pocket sliding doors integrated with Turner Sand TSS tall units

2. TALL UNITS

Tall units with Turner Sand TSS fronts
Tondone handles in matt Nero assoluto lacquered knurled metal
Plinth in Turner Sand lacquered aluminium

3. CENTOTTANTA

180° Swing door opening system
Turner Sand TSS front

4. SHELVES

60 mm thick bushhammered Iseo Gris MDI shelves with integrated lighting

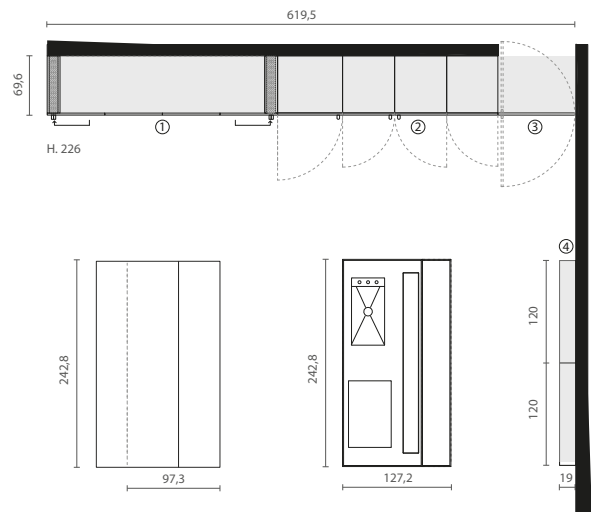

Finishes



- a. Turner Sand TSS
b. Matt Nero assoluto lacquered knurled metal
c. Bushhammered Iseo Gris MDI

REMARKS: Elements from the LAIN project are shown in grey.

Project

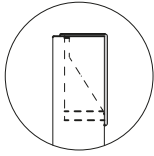

ANTIS PLAN

CROSS



Technical features

1. ANTIS PLAN - ISLAND

Base units with brown wood Canetè plus fronts
Ultra-thick "Work" worktop in 220 mm bushhammered Iseo gris Inalco MDI
Matt nero assoluto lacquered recessed Cross handle
Brown wood plinth

2. GAP

Matt nero lacquered aluminium kitchen counterback flush with the worktop

3. ANTIS PLAN - ISLAND

Base units with brown wood Canetè plus fronts
12 mm thick worktop in bushhammered Iseo Gris Inalco MDI
Matt nero assoluto lacquered recessed Cross handle
Brown wood plinth
60 mm thick, plain brown wood, "Fast" sliding breakfast table

4. CABINET FOLDING

Base units with plus brown wood Canetè fronts
Matt nero assoluto lacquered recessed Cross handle
12 mm thick worktop and splashback in bushhammered Iseo Gris Inalco MDI with "Step" upstand
60 mm thick shelves in plain brown wood

5. SHELVES

60 mm thick bushhammered Iseo Gris MDI shelves with integrated lighting

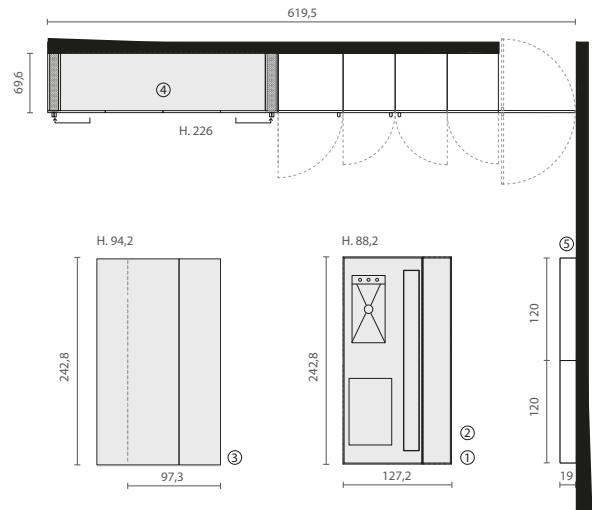

Finishes



- a. Brown Wood Canetè Plus
- b. Bushhammered Iseo Gris MDI
- c. Matt nero assoluto lacquered aluminium

REMARKS: Elements from the ANTIS project are shown in grey.