

Design R&D Euromobil and Roberto Gobbo

## Project

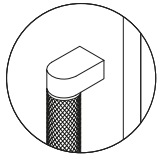

LAIN PLAN

TONDONE



## Technical features

### 1. CABINET FOLDING

A storage system featuring pocket sliding doors integrated with Turner Sand TSS tall units

### 2. TALL UNITS

Tall units with Turner Sand TSS fronts  
Matt absolute black lacquered, knurled iron Tondone handle  
Turner Sand plinth

### 3. CENTOTTANTA

180° Swing door opening system  
Turner Sand TSS front

### 4. SHELVES

60 mm thick bushhammered Iseo Gris MDI shelves with integrated lighting

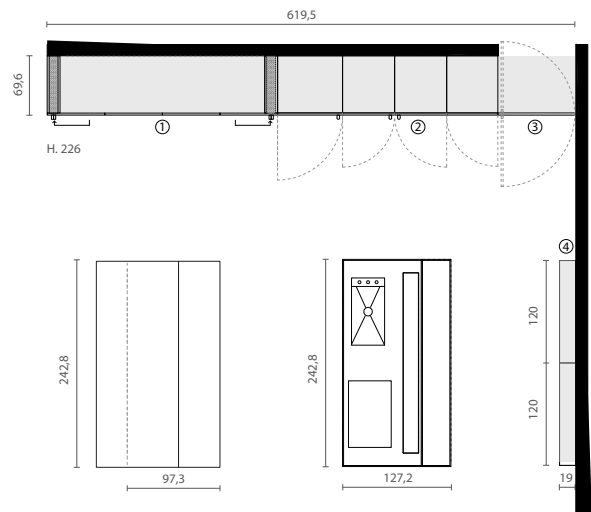

## Finishes



- a. Turner Sand TSS
- b. Matt absolute black lacquered knurled iron
- c. Bushhammered Iseo Gris MDI

REMARKS: Elements from the LAIN project are shown in grey.

Design R&D Euromobil and Roberto Gobbo

## Project

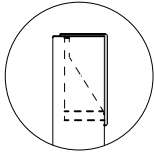

ANTIS PLAN

CROSS



## Technical features

### 1. ANTIS PLAN - ISLAND

Base units with brown wood Canetè plus fronts  
Ultra-thick "Work" worktop in 220 mm bushhammered Iseo gris Inalco MDI  
Matt absolute black lacquered recessed Cross handle  
Brown wood plinth

### 2. GAP

Matt black lacquered aluminium kitchen counterback flush with the worktop

### 3. ANTIS PLAN - ISLAND

Base units with brown wood Canetè plus fronts  
12 mm thick worktop in bushhammered Iseo Gris Inalco MDI  
Matt absolute black lacquered recessed Cross handle  
Brown wood plinth  
60 mm thick, plain brown wood, "Fast" sliding breakfast table

### 4. CABINET FOLDING

Base units with plus brown wood Canetè fronts  
Matt absolute black lacquered recessed Cross handle  
12 mm thick worktop and splashback in bushhammered Iseo Gris Inalco MDI with "Step" upstand  
60 mm thick shelves in plain brown wood

### 5. SHELVES

60 mm thick bushhammered Iseo Gris MDI shelves with integrated lighting

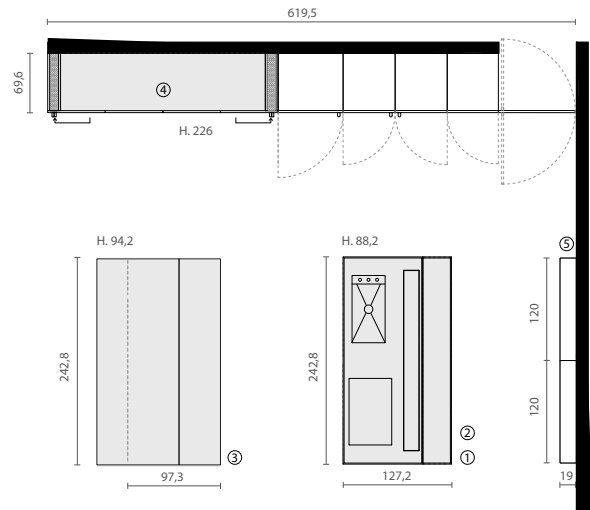

## Finishes

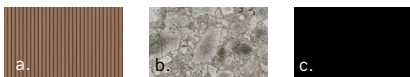

- a. Plus Brown wood Canetè
- b. Bushhammered Iseo Gris MDI
- c. Matt absolute black lacquered aluminium

REMARKS: Elements from the ANTIS project are shown in grey.